

Vu.City services

We provide a 3D digital modelling service to support our townscape, heritage and planning advice

The software enables us to import a 3D model of a development proposal and place it into an accurate 3D model of the existing townscape. This allows us to walk through views of a scheme in its context, test different height and massing options, and quickly understand and illustrate potential impacts on key views and the significance of heritage assets.

The software also includes useful datasets such as projected views, conservation areas, listed buildings and trees.

We can:

- Run interactive workshops with clients and design teams
- Instantly test different options for a development to help inform key design decisions and optimise development potential of sites
- Liaise with planning authorities, providing guidance on the use of Vu.City and interpretation of the model images generated by Vu.City

Vu.City 3D city models are currently available for:



Technical requirements

Vu.City can import from multiple software programs. Models need to be prepared in fbx file format as a geolocated 3D massing model with a low polycount. Further details on the required file format are provided here: <https://vu.city/knowledge-base/importing-a-model-legacy/>

Our Vu.City products and services:

- Interactive workshops
- Height and massing option testing
- Key views document (to support planning applications and pre-application negotiations)
- Initial ZTV/Viewshed analysis
- Interpretation of Vu.City images (heritage, townscape and planning advice)
- Initial representative view analysis

Key contacts



Joanna Ede
Director
Townscape, Head of
Landscape & VIA
joanna.ede@turley.co.uk
0207 851 4018



Rosa Gonzalez
Consultant
Landscape, Townscape
and VIA
rosa.gonzalez@turley.co.uk
020 7851 4021



Roger Mascal
Senior Director
Head of London and
Heritage & Townscape
roger.mascal@turley.co.uk
0207 851 4045



Richard Brookes
Director
Heritage & Townscape
richard.brookes@turley.co.uk
0207 851 4044

Turley

View testing



Existing



Proposed

Interactive workshops

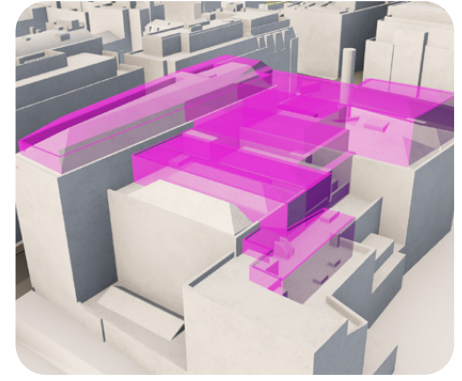

Roof extension

Height and massing option testing



Consented developments Under construction

London

Opportunities and constraints



Name
CENTRAL PUBLIC LIBRARY

Grade
II*

Location
Manchester, M2

List Date
1974-10-03

Easting
383865

Northing
397942.3608

Available data*

- Conservation areas
- Listed buildings
- Time line (approved developments)
- Height constraints
- Protected views
- Uses
- and more

* available data varies between cities

Listed buildings

Manchester